

5.00

PROFILES

Hunter Rainwater Systems



The Hunter Surefit system offers significantly reduced installation times and is integral to all 125mm joint brackets, angles, outlets, and external stop ends. Simply snapping in the lengths of guttering ensures speedy, positive location at all joints saving time and money.



5.00 125

- Surefit clipping system for fast installation
- Greater flow capacity
- Ideal for domestic or light commercial buildings
- Choice of downpipes

Profile Dimensions (mm)

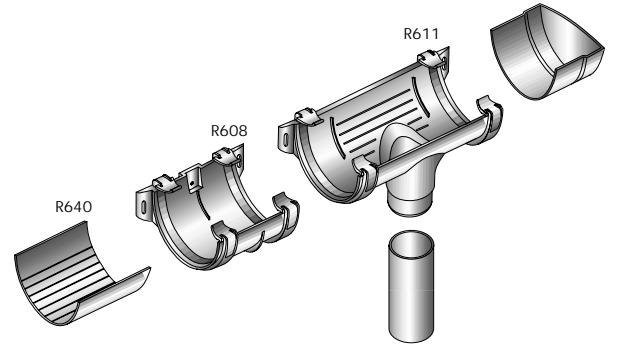
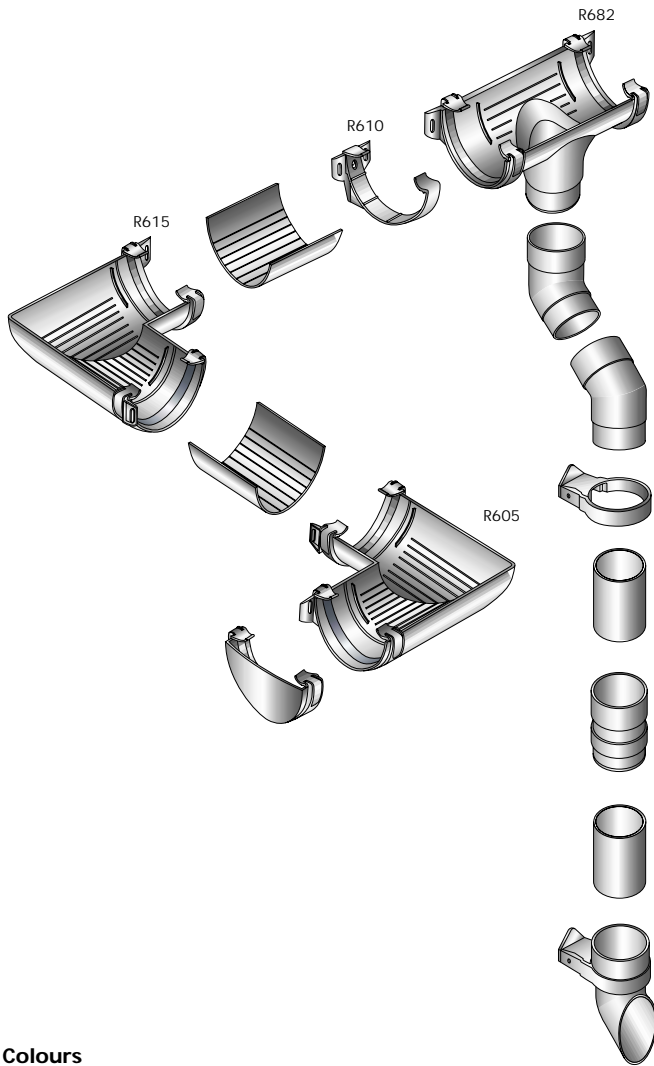
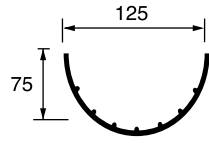

CHOICE OF DOWNPIPES



R611 - uses 68mm round downpipe
R682 - uses 82mm round downpipe

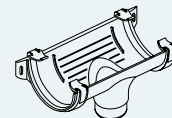

R611
68mm
outlet

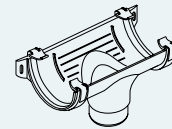

R682
82mm
outlet

Colours

Black	Grey	Van Dyke Brown	White
●	●	●	●

General colour range - see Hunter Trade Price List or website for specific colour availability.



R611 - uses 68mm round downpipe
R682 - uses 82mm round downpipe

GUTTER AND FITTINGS 125

5.01 Gutter

Nominal size mm	A	B	Length m	Code
125	72	124	4	R640

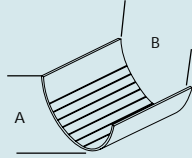

5.02 Joint bracket

Nominal size mm	A	B	C	Code
125	145	26	121	R608

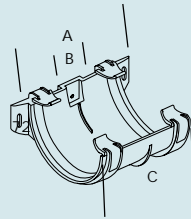

5.03 Support bracket

Nominal size mm	A	B	Code
125	139	72	R610

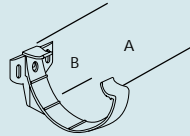

5.04 Angle bracket

90° External	R605
90° Internal	R615
135° External	R607
135° Internal	R617

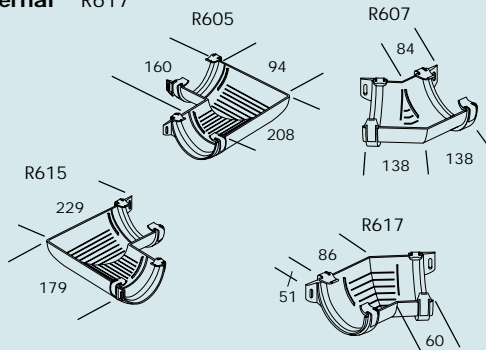

Complete with fixing wings

5.05 Running outlet

Nominal size mm	A	B	C	D	E	Code
68	275	157	159	40	251	R611
82	275	157	159	40	251	R682

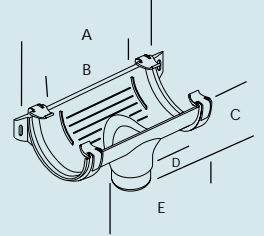

5.06 Stopend external

Nominal size mm	A	Code
125	External 42	R613

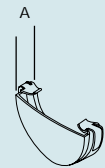

5.07 Stopend internal

Nominal size mm	A	B	Code
125	Internal 86	38	R602

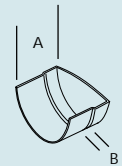

5.08 Adaptor seal

Nominal size mm	Code
125	R600

Replaces standard seal allowing connection of other deep profile gutter systems



5.09 Galvanised rise and fall bracket

	A	B	C	Code
230mm stake	122	100	210	R601

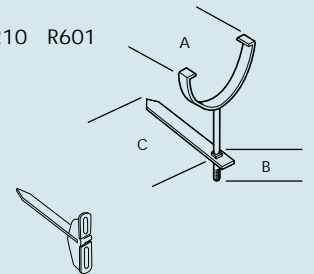

Variable 230mm stake R26
Variable 300mm stake R27

5.10 Plain ended pipe

Nominal size mm	Length m	A	Code
68	2		R518
68	2.5		R519
68	4		R520
68	5.5		R521
82	4	82	R700

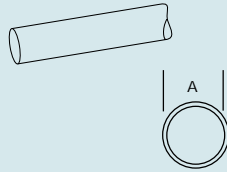

5.11 Bracket 1 screw fix

Nominal size mm	A	Code
68	1 screw	R19

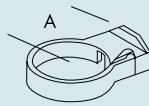

5.12 Bracket 2 screw fix

Nominal size mm		A	B	C	Code
68	2 screws	107	86	65	R46
82	2 screw	125	110	80	S612

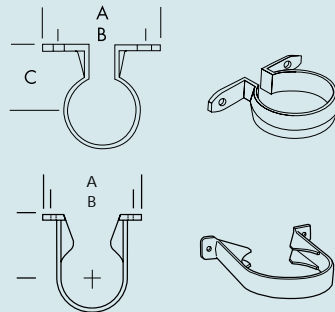

5.13 Connector

Nominal size mm	A	B	Code
68 Pipe	87	103	R17
82 Pipe	87	103	R717

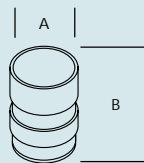

5.14 Drain connector - external use only

Nominal size mm	Code
50, 65, 68	DS24

Multi rainwater adaptor (Flexible)
Fits 110mm pipe or socket
Available in black only



5.15 Bends

92 1/2° - 68mm

Nominal size mm	A	B	Code
68	21	93	R577

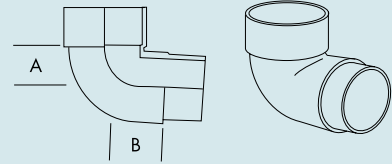

Standard offset using 2 bends = 119mm

112 1/2° offset 68/50mm

Nominal size mm	A	B	Code
68	35	35	R20
82	26	22	R720

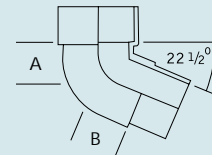

Standard offset using
2 x 68mm bends = 87mm

Standard offset using
2 x 50mm bends = 75mm

5.16 Rainwater shoe

Nominal size mm	A	B	C	Code
68	22	62	118	R21
82	22	62	118	R721

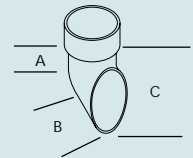

5.17 Access pipe

Nominal size mm	A	B	C	Code
68	45	50	185	R1

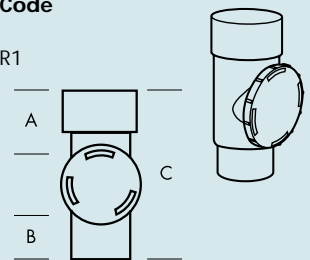

5.18 Reducer

Nominal size mm	Code
-----------------	------

68 R4
82mm spigot to 68mm socket

68 R3
110mm socket to 68mm socket

