

# 5.00

# PVCu SOIL AND VENTILATION SYSTEMS

## Hunter Soil Systems

5.01  
to  
5.13 Pipework and sizing

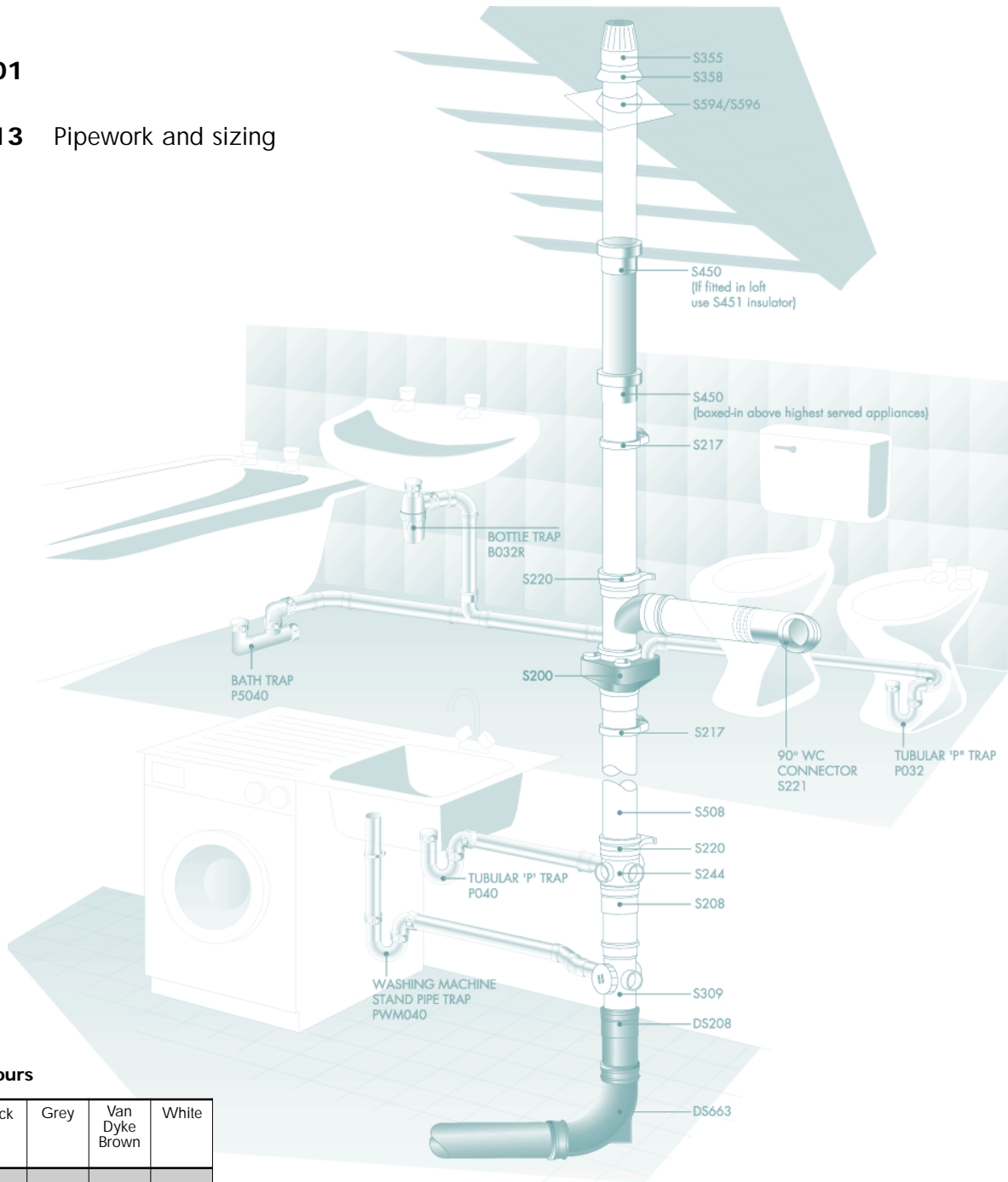

### Colours

Black	Grey	Van Dyke Brown	White
●	●	●	●

General colour range - see Hunter Trade Price List or website for specific colour availability.

# 5.01

## Pipe

### SOIL SYSTEM PIPE

#### Plain Ended

Size	Length	Code	A
82mm	3m	S599	82
82mm	4m	S600	82
110mm	2.5m	S579	110
110mm	3m	S505	110
110mm	4m	S506	110
110mm	1m	S204	110
160mm	3m	S534	160
160mm	4m	S535	160

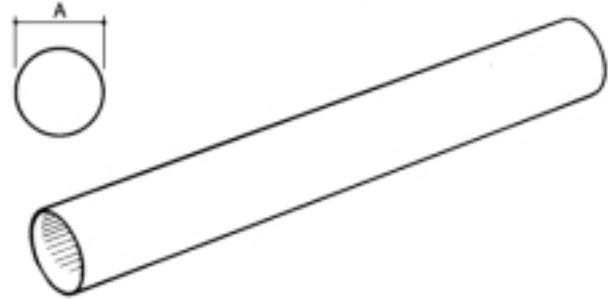

#### Single Socketed

Size	Length	Code	A
82mm	3m	S602	103
82mm	4m	S603	103
110mm	2m	S507	127
110mm	2.5m	S580	127
110mm	3m	S508	127
110mm	4m	S509	127
110mm	6m	S549	127
160mm	3m	S533	190
160mm	4m	S532	190
160mm	6m	S530	190

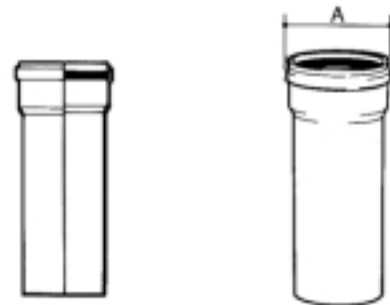

# 5.02

## Socket & Coupling

### SOIL SYSTEM SOCKET AND COUPLING

#### Single Socket

Size	Code	A	B	C	D
82mm	S604	110	3	103	60
110mm	S208	110	5	132	56
160mm	S406	175	5	190	97

#### Slip Coupling

Size	Code	A	B	C
82mm	S605	130	103	60
110mm	S211	150	132	72
160mm	S410	185	190	97

#### Double Socket (Solvent Weld)

Size	Code	A	B
110mm	S210	100	3

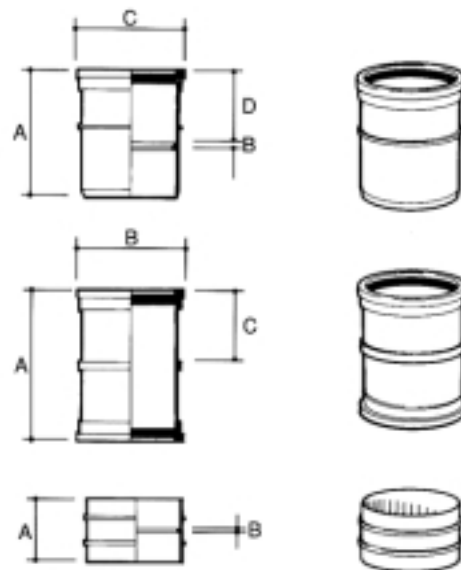

# 5.03

## Bracket

### SOIL SYSTEM BRACKET

#### Pipe Bracket

Size	Code	A	B	C
82mm	S612	125	110	80
160mm	S412	83	120	36

Note: S612 - 2 Screw fixing, S412 - 1 Screw fixing

#### Pipe/Snap Fit - Single Screw Fixing

Size	Code	A	B	C
110mm	S217	50	90	36

#### Pipe Bracket

Size	Code	A	B	C
110mm	S219	139	91	36

#### Socket

Size	Code	A	B	C
82mm	S607	115	75	33
110mm	S220	158	90	31

Internal Diameter of Ring Pipe Socket Bracket 111mm, Socket Bracket 119mm

#### Pipe/Socket

Size	Code	A	B	C
110mm	S570	146	90	30
160mm	S571	200	120	27

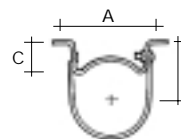
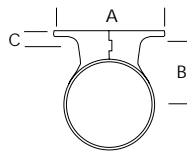
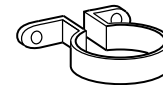
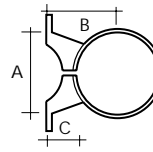
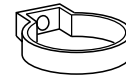
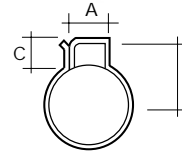
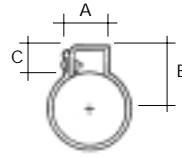
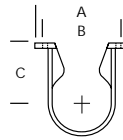

# 5.04

## Boss Pipe

### SOIL SYSTEM BOSS PIPE

#### Spigot Tail - 50mm open boss

Size	Code	A	B
82mm	S608	85	40
110mm	S244	110	50

N.B. 82mm - One open boss only (No side bosses)

#### Solvent Socket Tail - 50mm open boss

Size	Code	A	B	C	D
110mm	S247	48	50	69	50

#### Short Boss Pipe - Solvent weld

Size	Outlet	Code	A	B
110mm	32mm	S216	125	66
110mm	40mm	S215	125	66
110mm	50mm	S218	125	66

#### Strap-On-Boss - 50mm open boss

Size	Code	A	B	C
82mm	S610	55	50	-
110mm	S343	55	50	-
160mm	S437	55	50	-
110mm	dual fix bolt not supplied			

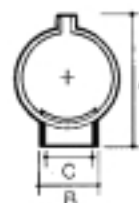
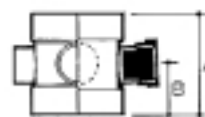
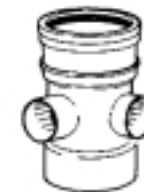
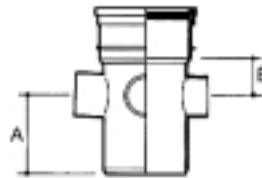

# 5.04

## Boss Pipe continued

### SOIL SYSTEM WASTE MANIFOLD

#### Pipe

Size	Code	A	B	C	D	E
110mm	S200	208	68	51	110	183

NOTE: One 50mm - open boss Three 50mm - closed bosses

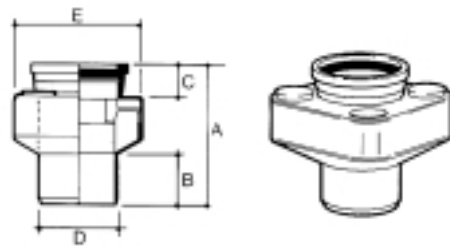

# 5.05

## Access Fitting

### SOIL SYSTEM ACCESS FITTING

#### Double Solvent Socket

Size	Code	A	B
110mm	S310	42	42

#### Spigot Tail

Size	Code	A	B	C
82mm	S616	56	56	116
110mm	S309	68	80	155
160mm	S472	105	55	140

#### Access Saddle

Size	Code	A
110mm	S337	135

#### Socket Plug

Size	Code	A	B
110mm	S214	65	138
160mm	S411	65	168

#### Access Cap - Spigot Tail

Size	Code	A	B	C
82mm	S618	20	60	98
110mm	S246	20	63	125

#### Access Cap - Solvent Socket Tail

Size	Code	A	B	C
110mm	S667	20	50	125

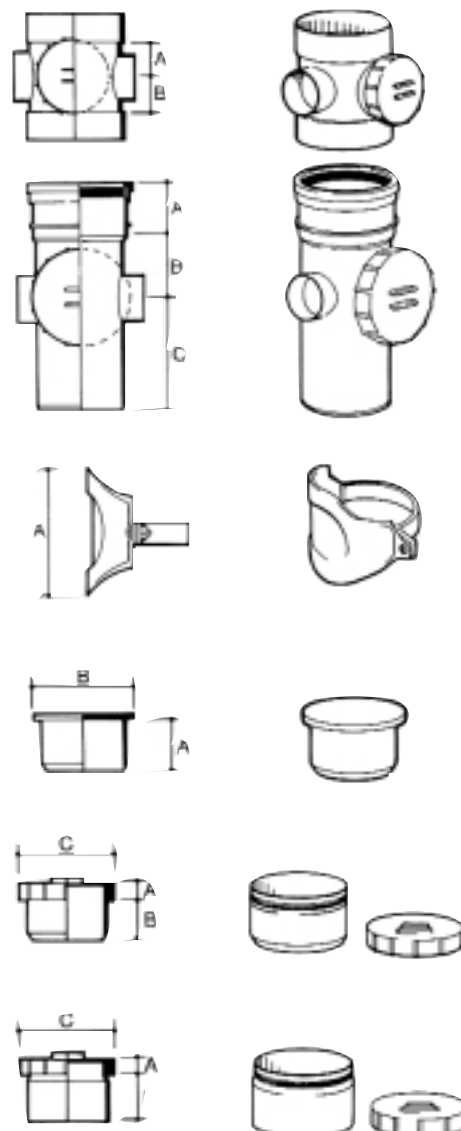

# 5.06

## Branch

### SOIL SYSTEM BRANCH

Access - 92 1/2° with rear access (no boss shoulders)

Size	Code	A	B	C
82mm	S615	35	150	100
110mm	S281	82	98	106

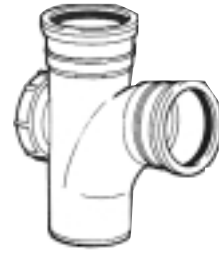
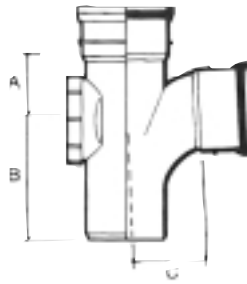

### Single Equal - 2 Unopened Boss Shoulders

Size	Angle	Code	A	B	C
82mm	92 1/2°	S611	35	150	100
110mm	92 1/2°	S269	60	155	85
110mm	104°	S272	85	175	100

(Rear entry boss is only on S269)

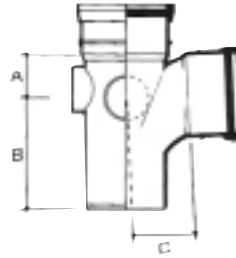

### Single Equal - No Bosses

Size	Angle	Code	A	B	C
82mm	135°	S614	105	81	105
110mm	92 1/2°	S334	85	155	100
110mm	112 1/2°	S336	105	145	95
110mm	135°	S278	140	107	140
160mm	92 1/2°	S427	85	265	155

(2 x 110mm unopened side bosses on S278 only)

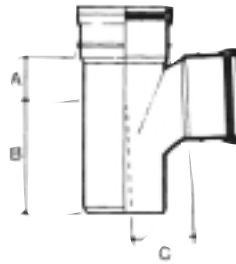

### Single Equal - 5 Unopened Boss Shoulders - Solvent Socket Tail

Size	Angle	Code	A	B	C
110mm	92 1/2°	S312	82	98	106

NB: Side bosses not suitable for S751 50mm boss adaptor

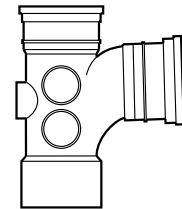
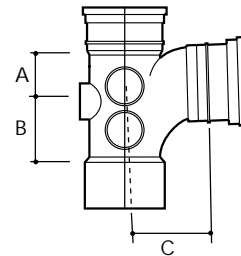

### Single Equal - 3 Unopened Boss Shoulders - Solvent Socket Top and Bottom

Size	Angle	Code	A	B	C
110mm	92 1/2°	S340	82	98	106

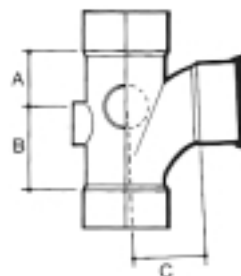

### Single Equal - 5 Closed Bosses - Triple Solvent Socket

Size	Angle	Code	A	B	C
110mm	92 1/2°	S292	85	105	100

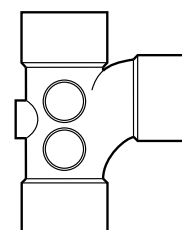
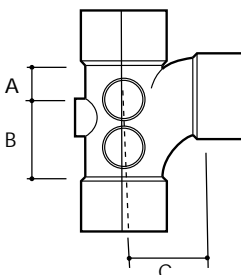

# 5.06

## Branch continued

### SOIL SYSTEM BRANCH CONTINUED

#### Double Equal - Body Only - 2 Unopened

Size	Angle	Code	A	B	C
110mm	112 $\frac{1}{2}$ °	S308	185	119	117

Note: Used in conjunction with Adaptor Bends on page 52

#### Single Unequal - Body Only - 2 Unopened Boss Shoulders (160mm x 110mm)

Size	Angle	Code	A	B	C
160mm	112 $\frac{1}{2}$ °	S443	232	137	138

Note: Used in conjunction with Adaptor Bends on page 52

#### Single Unequal - No Bosses (160mm x 110mm)

Size	Angle	Code	A	B	C
160mm	135°	S471	90	80	200

#### Double Branch - Triple Expansion Socket (Fabricated)

Size	Code	A	B	C
110mm	S295	60	155	85

#### Corner Branch - Triple Expansion Socket (Fabricated)

Size	Code	A	B	C
110mm	S296	60	155	85

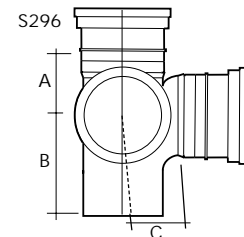
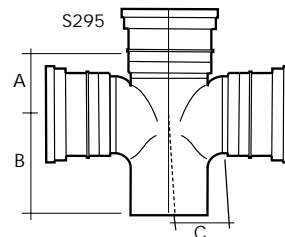
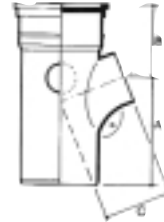
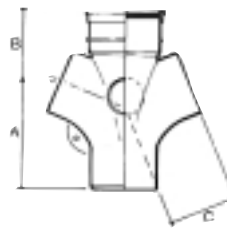

# 5.07

## Offset Bends

### SOIL SYSTEM OFFSET BENDS

#### Top Offset - 112 $\frac{1}{2}$ ° Solvent Socket Tail

Size	Code	A	B
82mm	S630	35	45
110mm	S270	64	67
160mm	S424	90	95

#### Bottom Offset - 112 $\frac{1}{2}$ ° Spigot Tail

Size	Code	A	B
82mm	S631	40	85
110mm	S271	63	121
160mm	S425	90	120

#### Top Offset - 112 $\frac{1}{2}$ ° Spigot Tail

Size	Code	A	B
82mm	S700	35	80
110mm	S263	90	130
160mm	S436	90	120

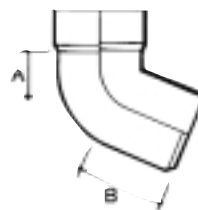
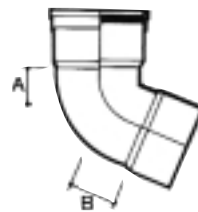

# 5.08

## Bends

### SOIL SYSTEM BENDS

#### Adaptor

Size	Angle	Code	A	B
110mm	160° to form 92½° branch	S323	15	10
110mm	170° to form 104° branch	S324	20	15

#### Access

Size	Angle	Code	A	B	C
82mm	92½°	S620	70	130	95
110mm	92½°	S326	105	180	77

Note: C = ID of Access

#### Spigot Tail

Size	Angle	Code	A	B
82mm	92½°	S619	70	130
82mm	135°	S621	45	90
110mm	92½°	S322	95	180
110mm	104°	S325	95	185
110mm	112½°	S328	95	160
110mm	135°	S331	38	95
160mm	92½°	S403	145	230
160mm	135°	S404	60	135

#### Solvent Socket Tail

Size	Angle	Code	A	B
82mm	92½°	S626	70	80
110mm	92½°	S319	95	95

#### Double Solvent Socket

Size	Angle	Code	A	B
110mm	92½°	S293	125	125
110mm	135°	S294	40	70

#### Expansion Socket Tail

Size	Angle	Code	A	B
110mm	92½°	S671	100	160

#### Adjustable Bend

Size	Angle	Code	A	B
110mm	5°-30°	S329	118	103

#### 92½° Long Spigot Tail Solvent Socket

Size	Angle	Code	A	B	C
110mm	92½°	S299	305	162	188

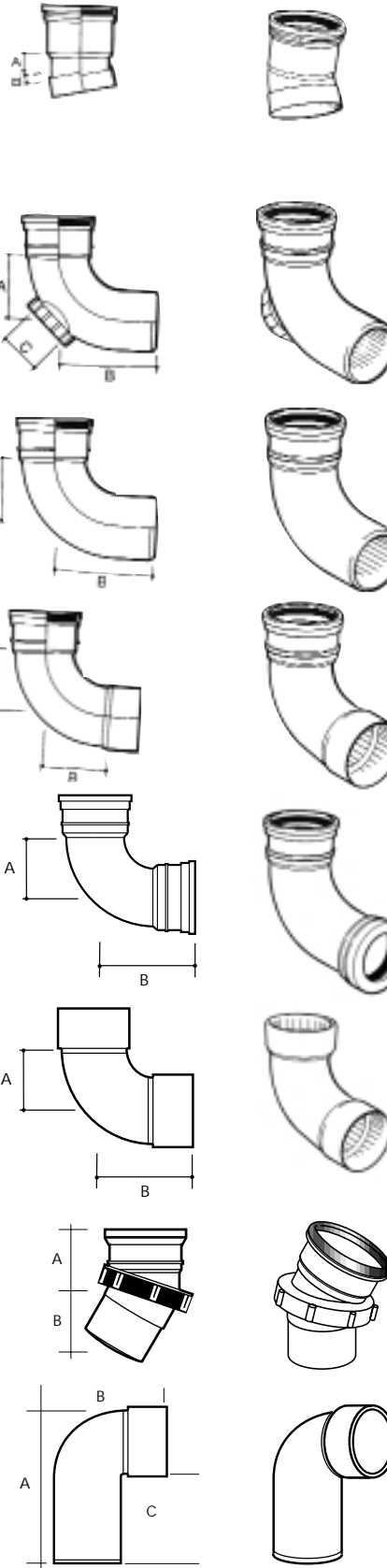

# 5.09

## Connectors to other materials

### SOIL SYSTEM CONNECTORS TO OTHER MATERIALS

#### PVCu to Cast Iron Socket (to BS416)

Size	Code	A	B
110mm	DS349	95	63

#### Straight - For Heat Shrinking

Size	Code	A	B
110mm	S121	65	55

Note: Fined tail for universal connection

#### Flexible PVC Gaskets - For Heat-Shrink Joints

Size	Code
110mm	S237

To be used in conjunction with S223 connectors

#### Eazisleeve Drain Adaptor Coupling

Size	Code
110mm	DS26
160mm	DS27

Complete with Stainless steel clips

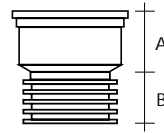

# 5.10

## Reducer-Level Invert

### SOIL SYSTEM REDUCER-LEVEL INVERT

#### 82mm x 50mm

Size	Code	A	B	C
82mm	S668	82	65	56

Accepts 50mm waste to BS EN1566:2000. Use with relevant reducer

#### 110mm x 50mm

Size	Code	A	B	C
110mm	S264	110	56	57

110mm spigot x 50mm socket. Available in grey only

#### 110mm x 82mm

Size	Code	A	B	C
110/82mm	S633	110	65	82

#### 160mm x 110mm

Size	Code	A	B	C
160mm	S420	160	68	110

#### 110mm x 32/40mm Flexible

Size	Code	A	B
110mm	DS25	110	53

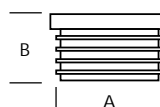
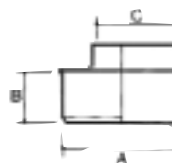
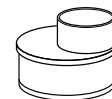
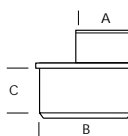
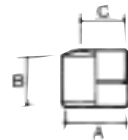

# 5.11

## Boss Adaptors for Closed or Open Bosses

### SOIL SYSTEM ADAPTORS FOR BOSS SHOULDERS & OPEN BOSSES

**Creates Solvent Connection to Boss** (for Solvent Pipe only)

Size	Angle	Code
32mm	Straight	W104
40mm	Straight	W106
50mm	Straight	S750
50mm	2½°	S753
50mm	90°	W725
32mm	90°	W104+W111
40mm	90°	W106+W112

**Creates Push-fit Connection to Boss** (for Push-fit & Solvent Pipe)

Size	Code
32mm	W58
40mm	W59
50mm	S751

Note: S751 is for Push-fit Pipe Only

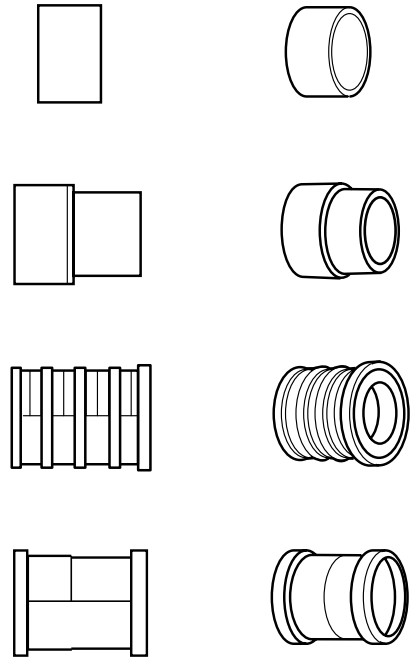

# 5.12

## Vent Pipe Fittings

### SOIL SYSTEM VENT COWL

**Vent Cowl**

Size	Code	A	B
82mm	S634	25	50
110mm	S355	48	80
160mm	S422	23	35

**Weathering Collar**

Size	Code	A
82mm	S635	55
110mm	S358	60
160mm	S423	60

**Extract Cover - For Extract Ventilation Pipes**

Size	Code	A	B
82mm	RV591	200	110
110mm	RV592	200	110
110mm	RVB592	200	110

82mm pipe gives a free area of 8775mm<sup>2</sup>

110mm pipe gives a free area of 9498mm<sup>2</sup>

160mm pipe gives a free area of 9346mm<sup>2</sup>

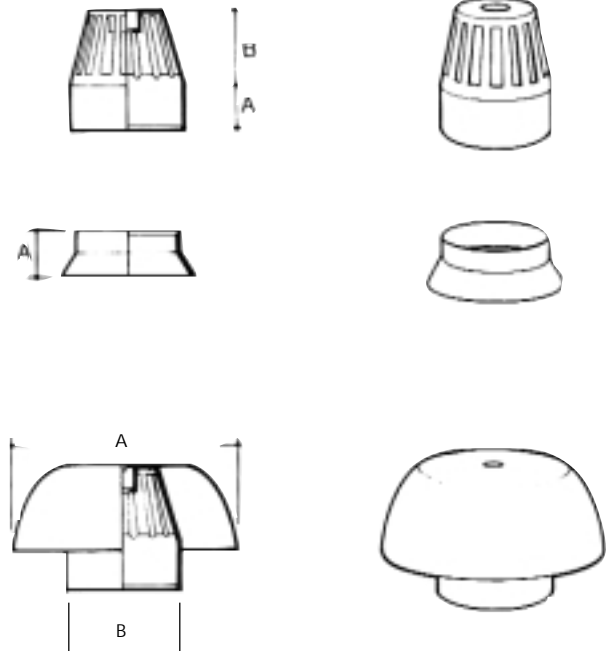

# 5.13

## Air Admittance Valve

### SOIL SYSTEM AIR ADMITTANCE

#### Air Admittance Valve

Size	Code	A	B	C	D	E
110mm	S450	96	137	28	50	110



#### Polystyrene Insulator for S450 (per Building Regulations)

Size	Code	A	B
110mm	S451	155	80

